



# NTS Series Double-Stage Liquid Ring Vacuum Pumps

Description: **Two-Stage Liquid Ring Vacuum Pump**

Models: **NTS - 140, 180, 300, 350 & 400**

Power Range: **7.5 - 25 HP**

Capacity Range: **100 - 280 CFM**

Max Vacuum: **28.9" Hg**

## Overview:

NES Company Inc. is proud to offer our new two stage NTS series liquid ring vacuum pumps. These pumps have a low maintenance, simple and reliable design capable of handling a variety of gases over a wide range of suction pressure. These pumps are well suited for dry and humid vacuum applications and can handle some liquid carry-over. High quality standard mechanical seals ensure reliable sealing and low shaft friction. All NES pumps are factory performance tested and guaranteed for a period of two years.



## Features:

- Wide Range of Suction Pressure [4" – 28.9" Hg]
- Standard Construction is Cast Iron with 304 Stainless Steel Impeller and shaft mechanical seals.
- Optional full 304 or 316 Stainless Steel construction.
- Available with optional single or double cartridge mechanical seals for better sealing.
- Available as a bare shaft pump or as part of an engineered system.
- 2-year factory warranty.

## Materials of Construction:

Part	Standard Material of Construction	Optional Material of Construction
Body	Cast Iron	304/316 Stainless Steel
Impeller	304 Stainless Steel	316 Stainless Steel
Shaft	Alloy Steel (2Cr13)	304/316 Stainless Steel
Shaft Seal	Component Mechanical Seals	Cartridge Mechanical Seals

## Applications:

- Vacuum Drying
- Degassing
- Pulp and Paper
- Evaporation
- Distillation
- Textile
- Filtering
- Power Plants

NES Company Inc.  
31 Fairfield Place  
West Caldwell, NJ 07006

(800) 297-3550  
[www.nescompany.com](http://www.nescompany.com)  
[info@nescompany.com](mailto:info@nescompany.com)



# NTS Series Double-Stage Liquid Ring Vacuum Pumps

Model	Speed (RPM)	Frequency (Hz)	Power	Capacity (ACFM)	Inlet (In.)	Discharge (In.)	Seal Water (In.)	Weight (lbs.)
NTS-140	1450	50	4 KW	85	1.5" FL	1.5" FL	1/2" NPT	165
	1750	60	7.5 HP	100				
NTS-180	1450	50	7.5 KW	110	1.5" FL	1.5" FL	1/2" NPT	180
	1750	60	10 HP	130				
NTS-300	1450	50	10 KW	170	2" FL	2" FL	1" NPT	315
	1750	60	15 HP	185				
NTS-350	1450	50	15 KW	200	2" FL	2" FL	1" NPT	340
	1750	60	20 HP	242				
NTS-400	1450	50	20 KW	250	2" FL	2" FL	1" NPT	405
	1750	60	25 HP	280				

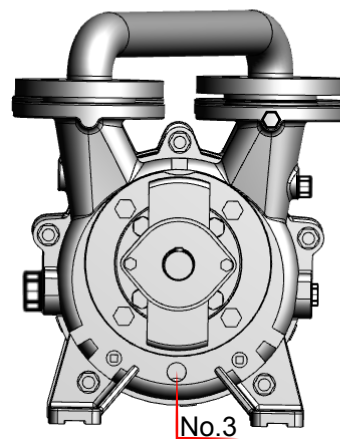
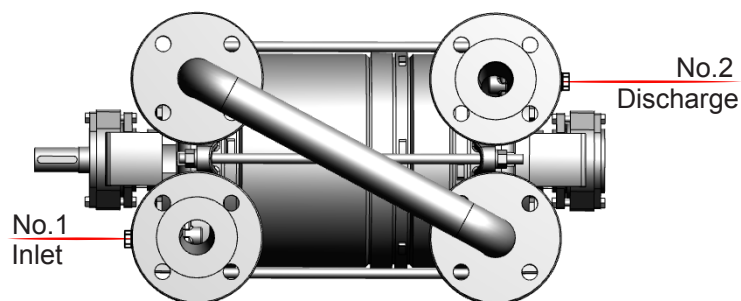
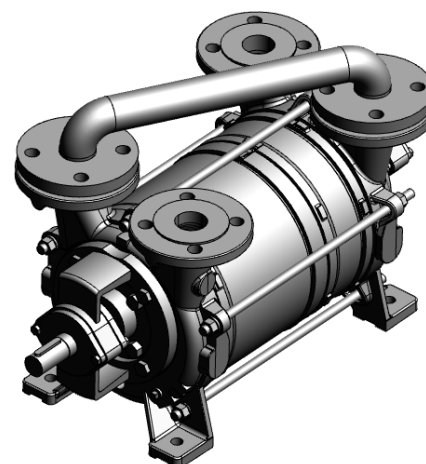
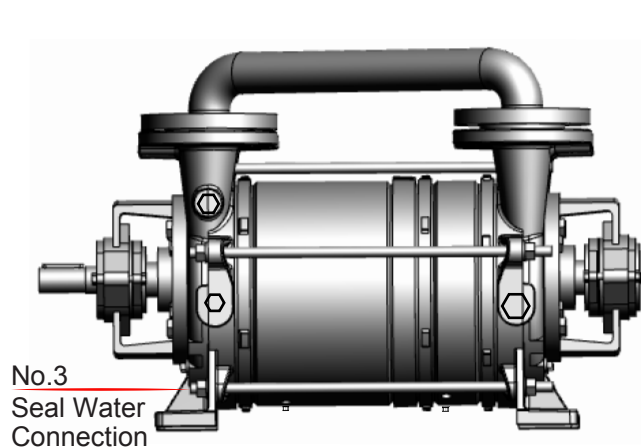

The information contained herein is provided as a convenience and for informational purposes only. Performance data are subject to manufacturing variation and test conditions including but not limited to atmospheric pressure, ambient temperature, seal fluid temperature, tolerances, and materials of construction. Performance of pumps constructed fully or partially of Stainless Steel may be lower due to larger clearances setting. The information may contain inaccuracies, errors or omissions. All NES Company Inc. supplied products and recommendations or suggestions must be evaluated by the end user to determine applicability and suitability for any particular use. See NES Company Inc. terms & conditions of sale for additional details which may also apply.

NES Company Inc.  
31 Fairfield Place  
West Caldwell, NJ 07006

(800) 297-3550  
www.nescompany.com  
info@nescompany.com

NTS Series Double-Stage Liquid Ring Vacuum Pumps

Rev: 1014.1  
© 2018 NES Company Inc.  
All rights reserved