

NTC Series Two-Stage Liquid Ring Vacuum Pumps

Models: NTC-5, NTC-7, NTC-11



Description: Two-Stage Liquid Ring Vacuum Pump

Models: NTC-5, NTC-7, NTC-11

Power Range: 15-150 HP

Capacity Range: 180-2100 CFM

Max Vacuum: 29" Hg

OVERVIEW

Our NTC series is an excellent choice for replacing or repairing your NASH* Classic TCM/TC Series liquid ring vacuum pumps. These drop-in replacement two stage pumps are directly interchangeable down to the part with the NASH* TCM/TC Series.

DESCRIPTION

These 5-150 HP sturdy vacuum pumps have high quality standard mechanical seals to ensure reliable sealing and low shaft friction. The construction of the NTC series models provides a long service life and a wide range of selection in power, ultimate vacuum level, and flow capacity. Available in NTC-5, NTC-7, NTC-11 (180 to 2100 CFM). Standard Construction is Cast Iron with Teflon packing. NES Company Inc. NTC Series pumps are performance tested and include a 2-year warranty against manufacturer's defects.



FEATURES

- Drop-in replacement for NASH* Classic TCM/TC series.
- Standard construction is Cast Iron with Teflon Packing.
- Optional 304 or 316 Stainless Steel construction.
- Optional factory installed mechanical seals.
- Parts and repair kits readily available.
- Available in bare pump, direct drive or V-belt systems
- 2-year factory warranty against manufacturer's defects.

NOTES

NES Company is proud to offer our Two Stage NTC Series liquid ring vacuum pumps. These pumps have been designed to be drop-in replacements for NASH* TCM/TC Series pumps. NES pumps are factory performance tested and include a 2-year warranty.

NES Company Inc. 333 Route 46 West, Building A, Fairfield, NJ 07004

(800) 297-3550 | www.nescompany.com | info@nescompany.com

© 2023 NES Company Inc. All rights reserved

NTC Series Two-Stage Liquid Ring Vacuum Pumps

Models: NTC-5, NTC-7, NTC-11



GENERAL TECHNICAL DATA

| Series Name | Replaces NASH | Motor Power [HP] | CFM | Vacuum @ Max CFM ["HgV] | Seal Water Usage (GPM) | Inlet [Inch] | Outlet [Inch] | Seal Water Connection Size [Inch] |
|-------------|---------------|------------------|-----------|-------------------------|------------------------|--------------|---------------|-----------------------------------|
| NTC-5 | TC-5 | 15-40 | 180-450 | 29 | 12-22 | 4 FL | 3 FL | ¾ NPT |
| NTC-7 | TC-7 | 25-60 | 320-720 | 29 | 15-25 | 6 FL | 4 FL | 1 NPT |
| NTC-11 | TC-11 | 60-150 | 1300-2100 | 29 | | 8 FL | 6 FL | 1 ½ BSP |

Variation Table

| Variations | Particulars |
|---------------|---|
| Metallurgy | Standard Cast Iron |
| | Stainless Steel 304 |
| | Stainless Steel 316L |
| | Duplex Steel |
| | Bronze |
| Direction | Clockwise |
| | Counter- Clockwise Rotation |
| Purpose | Vacuum Pump |
| | Compressor |
| Sealing | Standard Available as Gland Packing |
| | Available with Single Seal |
| | Available with Single Cartridge Seal |
| | Available with Dual Cartridge Seal and Seal Pot |
| Configuration | Once Through |
| | Partial Recovery |
| | Full Sealant Recovery |
| | Other System Configuration |
| | Simplex |
| | Duplex |
| | Triplex |
| | Quadruplex |

NES Company Inc. 333 Route 46 West, Building A, Fairfield, NJ 07004

(800) 297-3550 | www.nescompany.com | info@nescompany.com

© 2023 NES Company Inc. All rights reserved

NTC Series Two-Stage Liquid Ring Vacuum Pumps

Models: NTC-5, NTC-7, NTC-11



Application table

Applications

Solvent Recovery
Vacuum Distillation
Reactor Vacuum
Condenser Exhauster
Sterilizers & Autoclaves
Vacuum Degassing
Reactor Drying
Deodorizing of Edible Oils & Fats
Hogging
Solvent Recovery
Pharmaceutical Processing
Chemical Processing
Container Filling
Filtering
Extruder Venting
Eviscerating
Foods & Fats

NES Company Inc. 333 Route 46 West, Building A, Fairfield, NJ 07004

(800) 297-3550 | www.nescompany.com | info@nescompany.com

© 2023 NES Company Inc. All rights reserved

NTC Series Two-Stage Liquid Ring Vacuum Pumps

Models: NTC-5, NTC-7, NTC-11



Pump Length, Height & Breadth

| Series Name | Length (Inches) | Height (Inches) | Breadth (Inches) |
|-------------|-----------------|-----------------|------------------|
| NTC-5 | 40.25 | 22.00 | 22.50 |
| NTC-7 | 50.50 | 25.75 | 27.63 |
| NTC-11 | 81.10 | 42.52 | 39.57 |

NTC Series Two-Stage Liquid Ring Vacuum Pumps

Models: NTC-5, NTC-7, NTC-11



Exploded View

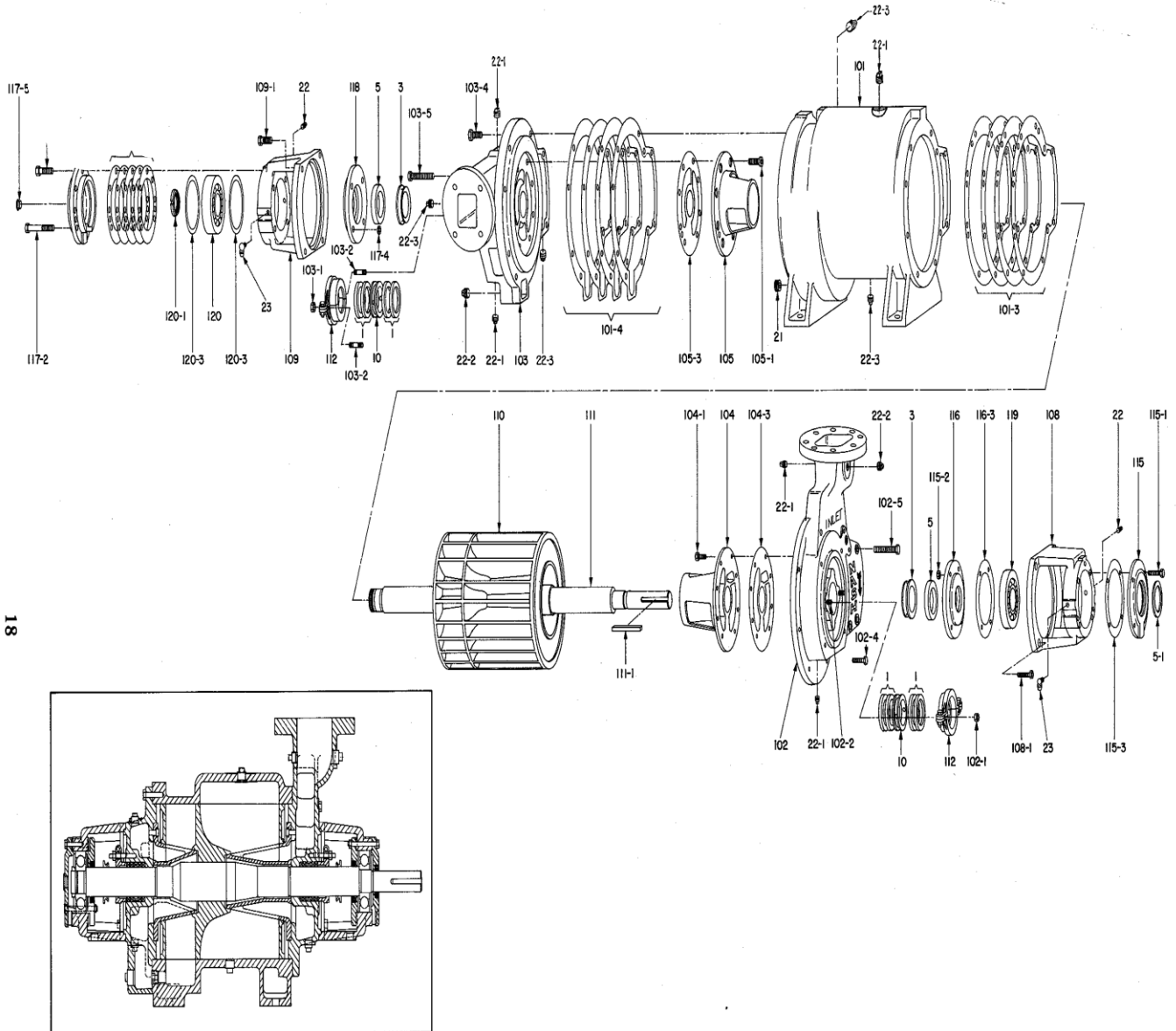

NES Company Inc. 333 Route 46 West, Building A, Fairfield, NJ 07004

(800) 297-3550 | www.nescompany.com | info@nescompany.com

© 2023 NES Company Inc. All rights reserved

NTC Series Two-Stage Liquid Ring Vacuum Pumps

Models: NTC-5, NTC-7, NTC-11



Bare Pump Weight

| Series Name | Stainless Steel (lb) | Cast Iron (lb) |
|-------------|-------------------------|-------------------|
| NTC-5 | 736 | 680 |
| NTC-7 | 1200 | 1100 |
| NTC-11 | - | 4688 |

NES Company Inc. 333 Route 46 West, Building A, Fairfield, NJ 07004

(800) 297-3550 | www.nescompany.com | info@nescompany.com

© 2023 NES Company Inc. All rights reserved